



NOON

MIRROR

The Noon Mirror is set back slightly from the frame separating the two forms and defining a tension between two surfaces. Framed in three alternating rings of timber in a walnut, rock maple and walnut combination. The timber defines a rich finish partnered with the highlight of the center rock maple ring.

The mirror is available in three finishes, clear, bronze and black and a combination of all these finishes in the Noon Tri-Cut configuration. Each mirror is Ø800mm and is supplied complete with a strong, easy to assemble wall-mounting system.

AVAILABLE MIRROR FINISHES



CLEAR
MIRROR



BRONZE
MIRROR



BLACK
MIRROR



TRI-CUT
MIRROR

DIMENSIONS

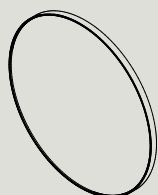

NOM
Ø800 D 30
Ø31.5" D 1.2"